

STATE HAWAII
DEPARTMENT OF LAND AND NATURAL RESOURCES
P. O. BOX 621
HONOLULU, HAWAII 96809

FOR DLNR USE ONLY

Reviewed by _____
Date _____
Accepted by _____
Date _____
File No. _____
EIS Required _____
PH Required _____

CONSERVATION DISTRICT USE APPLICATION

(Print or Type)

(Survey distance: 10+ miles)

- I. LANDOWNER (If State land, to be filled in by Gov't. Agency in control of property).

Name Campbell Estate

Address THE ESTATE OF JAMES CAMPBELL
828 Fort Street Mall, Suite 500
Honolulu, Hawaii 96813

Telephone No. _____

SIGNATURE [Signature]

- II. APPLICANT (Omit if applicant is landowner).

Name R. M. Towill Corporation

Address 677 Ala Moana Blvd.
Suite 1016
Honolulu, Hawaii 96813

Telephone No. 524-8200

Interest in Property survey purposes
(Indicate interest in property; submit written evidence of this interest).

SIGNATURE [Signature]

- III. USE REQUESTED -- DESCRIPTION OF AREA

District Puna

Island Hawaii

County Hawaii

Tax Map Key 1-2-08:1
1-1-01:1 & 1-1-08:1

Area of Parcel 26,545 Acres
(Indicate in acres or sq. ft.).

Area of Proposed Use 72 Acres
(Indicate in acres or sq. ft.).

Name & Distance of Nearest Town or Landmark Adjacent to Volcanoes N.P. and Fern Forest Subdivision

Boundary Interpretation (If the area is within 40 feet of the boundary of the Conservation District, include map showing interpretation of the boundary by the the State Land Use Commission).

Conservation District District Subzone L

County General Plan Designation Conservation

- IV. TYPE OF USE REQUESTED (Mark where appropriate).

1. Permitted Use (exception occasional use): DLNR Chapter 2, Section 13-2-11 Subzone L Item C-1
2. Accessory Use (accessory to a permitted use): DLNR Chapter 2, Section _____; Subzone _____.
3. Occasional Use: Subzone _____.
4. Temporary Variance: Subzone _____.
5. Conditional Use: Subzone _____.

- V. FILING FEE

1. Enclose \$50.00. All fees shall be in the form of cash, certified or cashiers check, and payable to the State of Hawaii.
2. If use is commercial, as defined, submit additional public hearing fee of \$50.00.

NOTE: Use additional sheets, as necessary, to provide the required information listed on pages 2 and 3.

INFORMATION REQUIRED FOR ALL USES

(Description of Parcel

- A. Existing structures/Use. (Attach description or map). Location Map
- B. Existing utilities. (If available, indicate size and location on map. Include electricity, water, telephone, drainage, and sewerage). None
- C. Existing access. (Provide map showing roadways, trails, if any. Give street name. Indicate width, type of paving and ownership). See Location Map
- D. Vegetation. (Describe or provide map showing location and types of vegetation. Indicate if rare native plants are present).
- E. Topography; if ocean area, give depths. (Submit contour maps for ocean areas and areas where slopes are 40% or more. Contour maps will also be required for uses involving tall structures, gravity flow and other special cases).
- F. If shoreline area, describe shoreline. (Indicate if shoreline is sandy, muddy, rocky, etc. Indicate cliffs, reefs, or other features such as access to shoreline).
- G. Existing covenants, easements, restrictions. (If State lands, indicate present encumbrances).
- H. Historic sites affected. (If applicable, attach map and descriptions). None

(Description: Describe the activity proposed, its purpose and all operations to be conducted.

III. Commencement Date: October 15, 1981

Completion Date: October 15, 1982

IV. Environmental Requirements

Pursuant to Chapter 343, Hawaii Revised Statutes, and in accordance with Section 1:30b of the EIS Regulations for applicant actions, an Environmental Assessment of the proposed use must be attached. The Environmental Assessment shall include, but not be limited to the following:

- A. Identification of application;
- B. Description of proposed use and statement of objectives;
- C. Description of affected environment, including appropriate maps and plans to show location, topography, site improvements, existing utilities and vegetation and archaeological/historical sites, if any. (See Page 3, Section I),
- D. General description of the technical, economic, social and environmental characteristics of the proposed use.

NOX The Environmental Assessment may be submitted in lieu of the information required above.

pk.

R.M. TOWILL CORPORATION

6592 /

677 ALA MOANA BLVD. • SUITE 1016
HONOLULU, HAWAII 96813
(808) 524-8200

Engineering • Planning • Photogrammetry • Surveying • Construction Management • Energy Systems

21 SEP 17 A7:55

September 15, 1981

STATE OF HAWAII
LAND AND NATURAL RESOURCES

Mr. Susumu Ono, Chairman
Board of Land and Natural Resources
Box 621
Honolulu, Hawaii 96809

Dear Mr. Ono:

In July of this year, True/Mid-Pacific Geothermal Venture submitted a proposal to Hawaii Electric Light Company for development of geothermal energy at Kahaualea, Puna, Hawaii. The land is owned by Campbell Estate and encompasses an area of 25,000 acres.

Previous reconnaissance and investigative volcanic studies, especially by the University of Hawaii, have pointed to a geothermal reservoir in the Puna district. Before any actual development can occur, exploratory drilling would be carried out. It is the intention of the Venture to apply for mining leases and drilling permits. However, before formal application can be made, the sites must be pin-pointed for the consideration of the Board of Land and Natural Resources. The area is zoned conservation, sub-zone "L", maps H-64 and H-69.

Our firm, R. M. Towill Corporation, has been retained as consultants by the Venture. In compliance with Title 13, Chapter 2 (Regulations No. 4), we request permission to conduct a ground survey to identify the drilling sites. This survey route will enable scientists to study the area preparatory to the completion of an environmental impact statement. Also, inspection by regulatory agencies after a conservation district application has been filed will be facilitated.

All work will be done by hand; no heavy equipment will be used. The survey routes to the drilling sites will be established by scientists to select the access least detrimental to the physical environment based on environmental research. This activity is a permitted use under Section 13-2-11, Item C-1. A sketch plan of the survey routes is enclosed for your review.

Your early consideration will be appreciated.

Very truly yours,

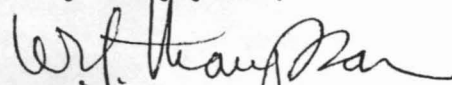

William Y. Thompson, Manager
Planning & Land Development Dept.

WYT:cs

Encl: Sketch Plan

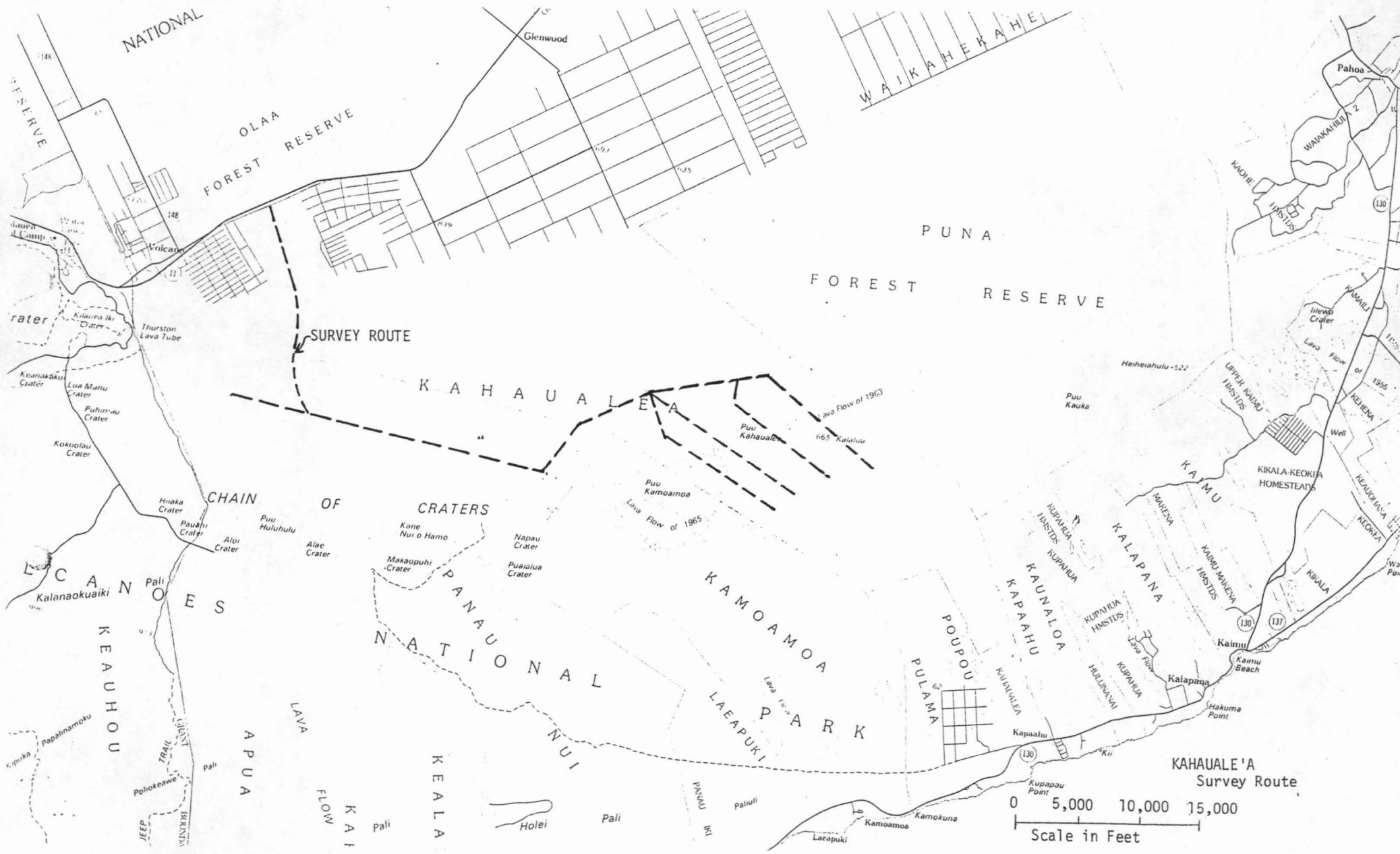

Mr. William Y. Thompson
Page 2
September 25, 1981

3. The proposed use qualifies as an exempt action in accordance with Section 1:33 of the Environmental Impact Statement Regulations.

Be it further advised that as the applicant it will be your responsibility to comply with the provisions of Section 205-29d, Hawaii Revised Statutes relating to Interim Coastal Zone Management (Special Management Area) requirements of the County of Hawaii, Planning Department.

Negative action on your application by the Board of Land and Natural Resources can be expected should you fail to obtain from the County of Hawaii authority, 30 days prior to the 180 day expiration date as noted on the first page of this notice, one of the following:

1. A determination that the proposed development is outside the Special Management Area (SMA);
2. A determination that the proposed development is exempt from the provisions of the County Ordinance and/or regulation specific to Section 205-29d, HRS; or
3. A Special Management Area (SMA) permit for the proposed development.

Pending action on your application by the Land Board in the near future, your cooperation and early response to the matter presented herein will be appreciated. Should there be any questions feel free to contact our Planning Office at 548-7837.

Very truly yours,

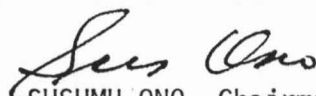

SUSUMU ONO, Chairman
Board of Land and Natural Resources

Enc. (receipt)

cc: Hawaii Board Member
Hawaii Land Agent
Department of Health
OEQC/EQC
COH/Planning Department
COH/Water Supply



DIVISIONS:
CONSERVATION AND
RESOURCES ENFORCEMENT
CONVEYANCES
FISH AND GAME
FORESTRY
LAND MANAGEMENT
STATE PARKS
WATER AND LAND DEVELOPMENT

STATE OF HAWAII
DEPARTMENT OF LAND AND NATURAL RESOURCES
P. O. BOX 621
HONOLULU, HAWAII 96809

September 25, 1981

REF. NO.: CPO-3552
File No.: TV HA-81-1
180-Day Exp. Date: TV

Mr. William Y. Thompson, Manager
R.M. Towill Corporation
677 Ala Moana Blvd., Suite 1016
Honolulu, Hawaii 96813

Dear Mr. Thompson:

NOTICE OF ACCEPTANCE AND ENVIRONMENTAL DETERMINATION
for Temporary Variance

Ground Survey Use at Puna, Hawaii

This acknowledges the receipt and acceptance for processing of your application for a Temporary Variance involving a ground survey to identify drilling sites on TMK's 1-1-01: 1 and 1-2-08: 1 at Puna, Hawaii.

According to your information, you plan to conduct a ground survey to identify drilling sites on TMK 1-1-01: 1 and 1-2-08: 1 at Puna, Hawaii.

This survey route will enable scientists to study the area preparatory to the completion of an Environmental Impact Statement. All work will be done by hand; no heavy equipment will be used.

After reviewing your application and attachments, we find that:

1. The proposed, ground survey use is not a zoned use of the Limited Subzone of the Conservation District according to Title 13 Chapter 2, as amended;
2. No public hearing pursuant to Section 183-41, Hawaii Revised Statutes (HRS), as amended will be required in that the proposed use is of a non-commercial nature; and



KAPAAHU to KIKALA, (MAUKA POR.) PUNA, HAWAII

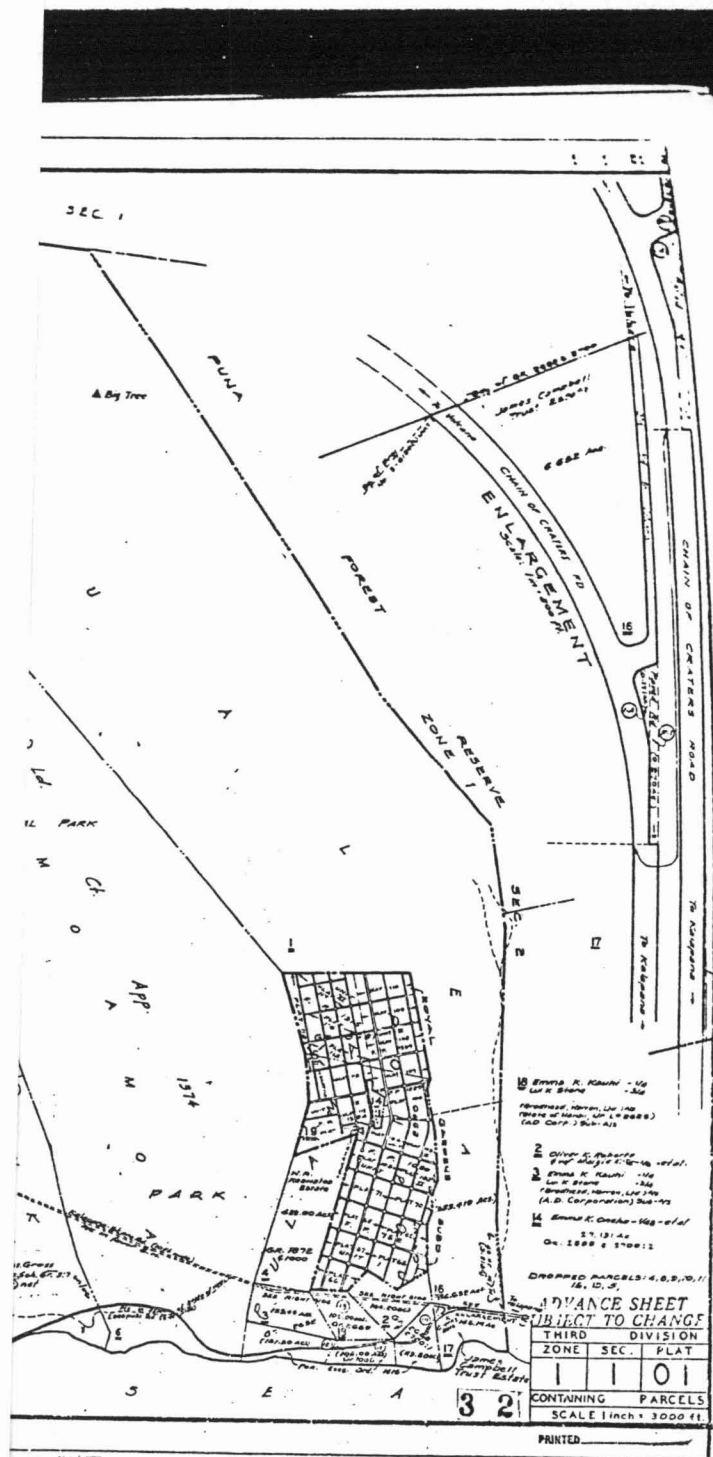

(7/16/81)
2880

State of Hawaii
Department of Land and Natural Resources
DIVISION OF AQUATIC RESOURCES

Date September 24, 1981

MEMORANDUM

TO: Henry M. Sakuda, Chief, Fisheries
THROUGH: Paul Kawamoto, Chief, Marine Section
Stanley Shima, Chief, Freshwater Section

FROM: David Eckert, Aquatic Biologist

SUBJECT: Comments on 1. Conservation District Use Application
x 2. Temporary Variance: TV-HA-81-1/CPO-3409

Comment	Date of	Date
Requested by <u>Roger Evans, Planning Office, DLNR</u>	Request <u>9/21/81</u>	Rec'd <u>9/22/81</u>

Summary of Proposed Project

Title: Geothermal well site surveys

Project by: R.M. Towill Corp.

Location: Vicinity Puu Kahaualea, Puna, Hawaii

Brief Description:

The applicant is a consultant to True/Mid-Pacific Geothermal Venture, which plans to develop geothermal resources on two parcels of Campbell Estate land, totaling 26,545 acres, in the vicinity of Puu Kahaualea. The applicant seeks authorization of ground surveys to identify drilling sites, preparatory to completion of an EIS. Only hand tools would be used, with access via routes chosen for "least detriment to the physical environment based on environmental research."

Our comments are required within four (4) working days.

Comment:

The proposed activity would take place in a region lacking perennial bodies of water. The project would reach no nearer than about four miles to the closest shoreline, and would involve small numbers of people for short periods using no heavy equipment. The project would have no impact on aquatic resources.

David Eckert
DAVID ECKERT



DIVISIONS:
CONSERVATION AND
RESOURCES ENFORCEMENT
CONVEYANCES
FISH AND GAME
FORESTRY
LAND MANAGEMENT
STATE PARKS
WATER AND LAND DEVELOPMENT

RECEIVED

SEP 22 1981

Division of
AQUATIC RESOURCES

STATE OF HAWAII

DEPARTMENT OF LAND AND NATURAL RESOURCES

P. O. BOX 621

HONOLULU, HAWAII 96809

September 21, 1981

REF. NO.: CPO-3409
FILE NO.: TV-HA-81-1

MEMORANDUM

TO: Land Management
DOFAW
DOAR
DOWALD
DOCARE
State Parks/Historic Sites
NARS

FROM: Roger C. Evans, Staff Planner
Planning Office

SUBJECT: Request for Temporary Variance from R. M. Towill Corporation for
Ground Survey to identify drilling sites on TMK 1-1-01: 14, 1-1-08: 1
at Puna, Hawaii

DIVISION OF AQUATIC RESOURCES		
DIRECTOR	<input checked="" type="checkbox"/>	Referral Date
FISH CHIEF	<input checked="" type="checkbox"/>	Suspense Date
MARINE SEC	<input checked="" type="checkbox"/>	Draft Reply <input type="checkbox"/>
F.W. SEC	<input type="checkbox"/>	Reply Direct <input type="checkbox"/>
AFRC	<input type="checkbox"/>	Comments <input checked="" type="checkbox"/>
SWERDLOFF	<input type="checkbox"/>	Information <input type="checkbox"/>
STAHL	<input type="checkbox"/>	Comp. Act & File <input type="checkbox"/>
	<input type="checkbox"/>	Return To
SECRETARY	<input type="checkbox"/>	Copies To:
OFF. SERV	<input type="checkbox"/>	Remarks:
FED. AID	<input type="checkbox"/>	

Attached for your review and comment is a request for temporary variance
in the Conservation District.

May we have your input by September 28, 1981.

A field inspection is not requested.

Should you have any questions, please contact me at 7837.

ROGER C. EVANS

Refer to attached staff comments
Kerpi Go
9/23/81



GEORGE R. ARIYOSHI
GOVERNOR OF HAWAII



STATE OF HAWAII
DEPARTMENT OF LAND AND NATURAL RESOURCES
DIVISION OF STATE PARKS
P. O. BOX 621
HONOLULU, HAWAII 96809

SEP 25 1981

DIVISIONS:
CONSERVATION AND
RESOURCES ENFORCEMENT
CONVEYANCES
FISH AND GAME
FORESTRY
LAND MANAGEMENT
STATE PARKS
WATER AND LAND DEVELOPMENT

September 23, 1981

MEMORANDUM

To: Roger Evans, Planning Officer
Planning Office

From: Ralston Nagata, Director
Historic Sites Program

Subject: Request for Temporary Variance for Ground Survey
(CPO-3409), R. M. Towill Corporation, Kahaualea,
Puna, Hawaii, TMK: 1-1-01:14 and 1-2-08:1

Thank you for the opportunity to review the subject undertaking.

A review of our records indicates that this project does not occur on historic properties that are listed on the Hawaii Register or the National Register of Historic Places, or that have been determined eligible for inclusion on the National Register of Historic Places.

Due to the lack of archaeological surveys in the vicinity, we are not aware that significant resources exist in the project area, this does not confirm the absence of historical, cultural, architectural and/or archaeological resources on the property. In the event that any previously unidentified sites or remains such as artifacts, shell, bone, or charcoal deposits; human burials; rock or coral alignments, pavings, or walls are encountered, please inform the applicant to stop work and contact our office at 548-7460 immediately.

The agency coordinating our department's response under the Chairman's signature should add "State Historic Preservation Officer" to his title as Chairman when the undertaking has any federal involvement including responses to a federal agency, A-95 responses, or involving federal funding, loan guarantee, permit or license.

RALSTON NAGATA

COPY

PLANNING DEPARTMENT
25 AUPUNI STREET

COUNTY OF HAWAII
HILO, HAWAII 96720

Rec'd Map. Div.
By _____
Gordon _____ Estelle _____
Aki _____ Post _____
B. _____
L. _____
C. _____
D. _____

OCT 02 1981

1981 OCT 2 1:36

NATURAL RESOURCES
STATE OF HAWAII

September 24, 1981

Mr. William Y. Thompson
677 Ala Moana Boulevard
Suite 1016
Honolulu, HI 96813

Dear Mr. Thompson:

SMA Use Permit Requirement
Research and Survey Activities
Tax Map Key: 1-1-01:01 and 1-2-08:1

This is in response to your letter of September 21, 1981, requesting information as to the Special Management Area Use Permit requirements for the proposed research and survey activities at Kahaualea, Puna, Hawaii.

Based on the information and maps submitted, we have determined that the subject activities will not be conducted within the boundaries of the Special Management Area, adopted pursuant to Chapter 205A, HRS, and Rule 9 of the Planning Commission.

Based on the above, an SMA Use Permit is not required for the survey activities in the above-described area.

Should you have any further questions on this matter, please feel free to contact William Moore or Wally Matsunami of this Department.

Sincerely,

Sidney Fuke
SIDNEY FUKU
Planning Director

WM:lp

cc: ✓DLNR, Planning Division

MEMO

DEPT. OF LAND & NATURAL RESOURCES
Division of State Parks
P. O. Box 621 • Honolulu, Hawaii 96809

RECEIVED

OCT 2 PM 1:20

TO Planning Office

DEPT. OF LAND
& NATURAL RESOURCES
STATE OF HAWAII

DATE Sept. 28, 1981

From: State Parks

SUBJECT Temporary Variance
from R.M. Towill Corp. for Puna, HI
Ref. No. CPO-3409, File No. TU-HA81-1

There are no State Park interests involved in this proposal.

Rec'd Plng. Ofc. OCT 02 1981
By _____
Gordon _____ Estelle _____
Ald _____ Post _____
Bogor ☒ Library _____
Lan _____
File in _____

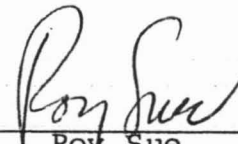
Roy Sue

GEORGE R. ARIYOSHI
GOVERNOR OF HAWAII

RECEIVED

'81 OCT 3



STATE OF HAWAII
DEPARTMENT OF LAND AND NATURAL RESOURCES
DIVISION OF CONSERVATION AND RESOURCES ENFORCEMENT

P. O. BOX 936
HILO, HAWAII 96720

October 6, 1981

DIVISIONS:
CONSERVATION AND
RESOURCES ENFORCEMENT
CONVEYANCES
FISH AND GAME
FORESTRY
LAND MANAGEMENT
STATE PARKS
WATER AND LAND DEVELOPMENT

By _____
Gordon _____
Adm _____
Hoyt _____
Len _____
File in _____
Return to _____

TO: ✓ Roger Evans, Staff Planner , DLNR Planning Office

VIA: Maurice Matsuzaki, Director, DOCARE

FROM: Charles K. Supe, Hawaii Branch Chief, DOCARE

SUBJECT: Comments on a Request for a Temporary Variance from
R.M. Towill Corporation for Ground Survey to identify
Drilling Sites on TMK: 1-1-01:14, 1-1-08:1 at Puna, Hawaii

Because the area is owned by the Estate of James Campbell
and the activity will be done on those properties, no
adverse comments are entertained and have no objections
to its approval.

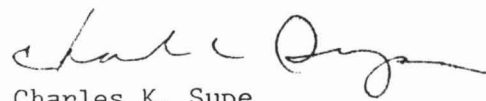
Charles K. Supe

CKS/mjy

NOV 10 1981

REF. NO.: CPO-3672
FILE NO.: TV-HA-81-1
Expiration Date: T.V.

Mr. William Y. Thompson, Manager
R. M. Towill Corporation
677 Ala Moana Blvd. Suite 1016
Honolulu, Hawaii 96813

Dear Mr. Thompson:

Subject: Temporary Variance for Ground Survey Use at Puna, Hawaii.

We are pleased to inform you that the Board of Land and Natural Resources, at its meeting of October 23, 1981, approved your application subject to the following conditions:

1. That the applicant comply with all applicable statutes, ordinances, rules and regulations of the Federal, State, and County governments and applicable parts of Section 6A and 6D of Departmental Regulation No. 4, as amended;
2. The applicant, its successors and assigns, shall indemnify and hold the State of Hawaii harmless from and against any loss, liability, claim or demand for property damage, personal injury and death arising out of any act or omission of the applicant, its successors, assigns, officers, employees, contractors, and agents under this permit or relating to or connected with the granting of this permit;
3. Other terms and conditions as prescribed by the Chairman;
4. In the event any unanticipated sites or remains, such as shell, bone or charcoal deposits, human burials, rock or coral alignments, pavings, or walls are encountered during construction, the applicant shall stop work and contact the Historic Preservation Office at 548-7460 or 548-6408;
5. Any work to be done on the land shall be completed within one (1) year of this approval date as it relates to this Temporary Variance.

Du

Mr. W. Y. Thompson
NOV 10 1981
Page 2

Should you have any questions on any of these conditions, please contact
Mr. Roger C. Evans of our Planning Office at 548-7837.

Very truly yours,

/s/ SUSUMU ONO

SUSUMU ONO, Chairman
Board of Land and Natural Resources

Attachments

cc: Hawaii Board Member
Hawaii Land Agent
Hawaii Planning Department

bcc: Land Management
DOWALD
Fish and Game
Historic Sites
Forestry
State Parks
OEOC
Dept. of Health

DU:sa

Alvin 

OFFICIAL
RECEIPTCash

2002

50000a 82152

DOCUMENT COPY