

(KMERGRS)

KILAUEA MIDDLE EAST RIFT
GEOTHERMAL RESOURCE SUBZONE

Legal Authority

Pursuant to Sections 205-5.1 and 205-5.2, Hawaii Revised Statutes, as amended by Act 151, SLH 1984; and Title 13, Chapter 184, Hawaii Administrative Rules, as amended; the Board of Land and Natural Resources, State of Hawaii, has designated the Kilauea Middle East Rift, Island of Hawaii, as a Geothermal Resource Subzone (GRS).

Location

The subzone area designated on the attached map is identified as the Kilauea Middle East Rift Geothermal Resource Subzone. The subzone area contains approximately 9,014 acres, more or less, and is located within the area formerly known as the Wao Kele 'O Puna Natural Area Reserve and includes a portion of the Upper Kaimu Homesteads. The GRS subzone area includes the following Tax Map Keys (TMK):

Tax Map Keys

TMK 1-2-08: Portions of 8, 12, 13, 16, and 17
TMK 1-2-08: 14 and 15
TMK 1-2-10: Portions of 1 and 3

Total: Approximately 9,014 acres, more or less.

The attached map defining the boundaries of the designated subzone is adapted from the U.S. Geological Survey topographic maps (Kalalua and Pahoa South Quadrangles).

Questions regarding the GRS and requests for information may be directed to the Division of Water and Land Development, Department of Land and Natural Resources, Room 227, Kalanimoku Building, 1151 Punchbowl Street, Honolulu, Hawaii 96813 (Telephone: (808) 548-7533).

KILAUEA (MIDDLE EAST) RIFT
GRS

TAX MAP KEY	AREA (ACRES)	LAND USE CLASSIF.	CURRENT LAND OWNER	OTHER
1-2-08-8 (PDR.)	37	AG/20ac	STATE OF HAWAII	
1-2-08-12 (PDR.)	2	AG/20ac	RONSTROM, ROBERT W.	
1-2-08-13 (PDR.)	37	AG/20ac	STATE OF HAWAII	
1-2-08-14	90	AG/20ac	STATE OF HAWAII	
1-2-08-15	80	AG/20ac	KAMAKANI, K. ESTATE et al YAMANOUCHI, ALBERT K. et al	
1-2-08-16 (PDR.)	41	AG/20ac	KAMELAHELA, SAMUEL JR.	
1-2-08-17 (PDR.)	21	AG/20ac	BRENNER, GAIL et al HEUER, MARK A. / LISA et al	
1-2-10-1 (PDR.)	310	AG/20ac	JAMES CAMPBELL ESTATE	FORMERLY STATE LAND
1-2-10-3 (PDR.)	8396	CONS.	JAMES CAMPBELL ESTATE	FORMERLY STATE LAND
9014		TOTAL ACREAGE IN SUBZONE		

KILAUEA MIDDLE EAST RIFT
GEOTHERMAL RESOURCE SUBZONE

Island of Hawaii

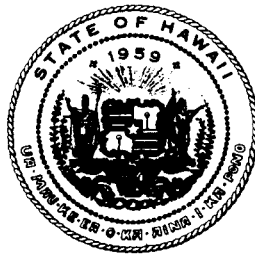

State of Hawaii
BOARD OF LAND AND NATURAL RESOURCES

April 1986

KILAUEA MIDDLE EAST RIFT
GEOTHERMAL RESOURCE SUBZONE

Legal Authority

Pursuant to Sections 205-5.1 and 205-5.2, Hawaii Revised Statutes, as amended by Act 151, Session Laws of Hawaii 1984, and Title 13, Chapter 184, Administrative Rules, as amended, the Board of Land and Natural Resources, State of Hawaii, has designated the Kilauea Middle East Rift, Island of Hawaii, as a Geothermal Resource Subzone (GRS).

Location

The subzone area is designated on the attached map identified as the Kilauea Middle East Rift Geothermal Resource Subzone. The subzone area contains approximately 9,014 acres more or less, subject to verification, and is located within the area formerly known as the Wao Kele 'O Puna Natural Area Reserve and includes a portion of the Upper Kaimu Homesteads. The GRS subzone area includes the following Tax Map Keys (TMK):

Tax Map Keys

TMK 1-2-08: portions of 8, 12, and 13
TMK 1-2-08: 14 and 15
TMK 1-2-08: portions of 16 and 17
TMK 1-2-10: portions of 1 and 3

The attached map defining the boundaries of the designated subzone is adapted from U.S. Geological Survey topographic maps (Kalalua and Paho South Quadrangles).

Questions regarding the GRS and requests for information may be directed to the Division of Water and Land Development, Department of Land and Natural Resources, Room 227, 1151 Punchbowl Street, Kalanimoku Building, Honolulu, Hawaii 96813 (telephone 548-7539).

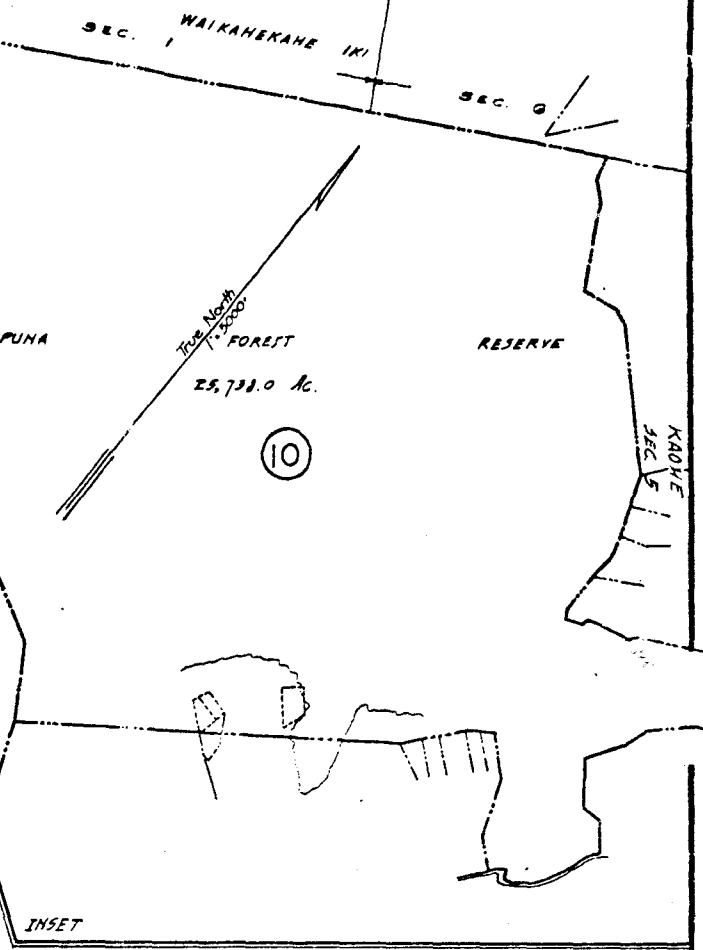
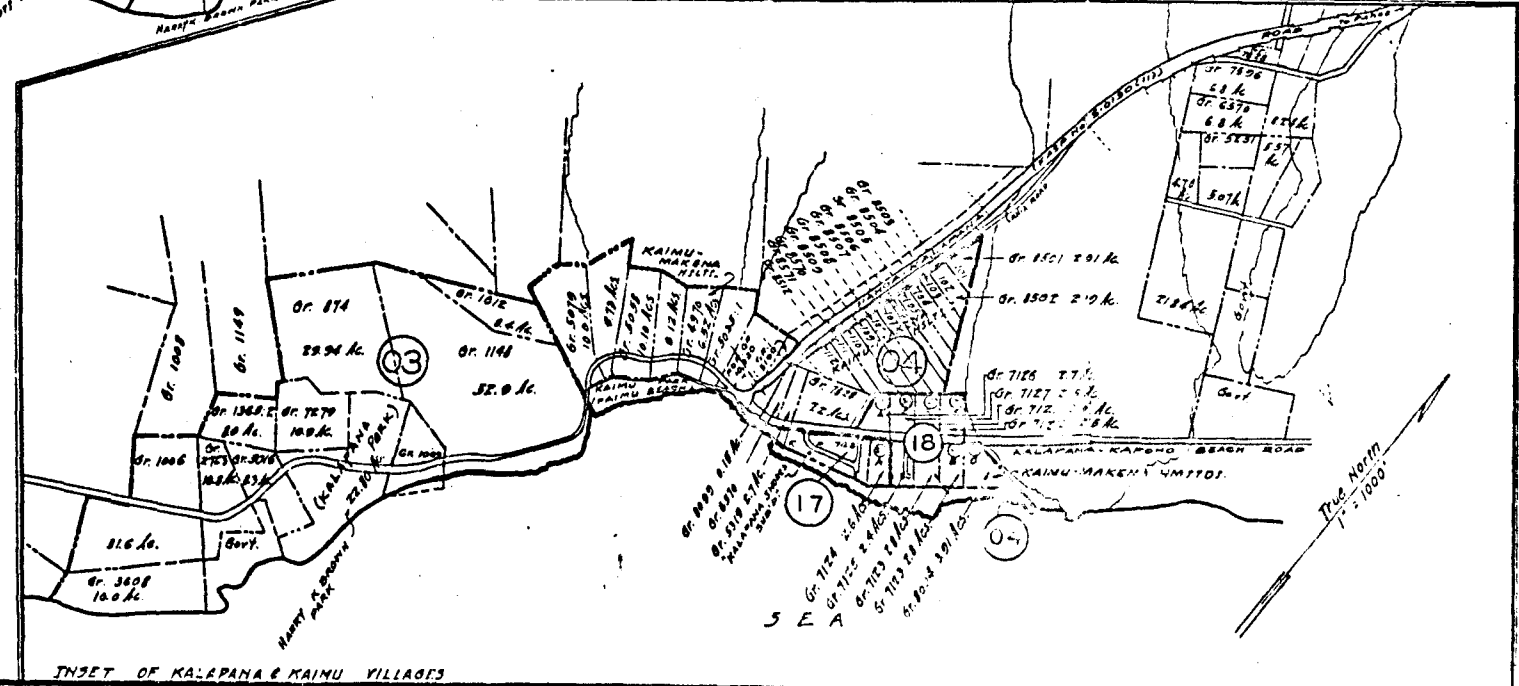
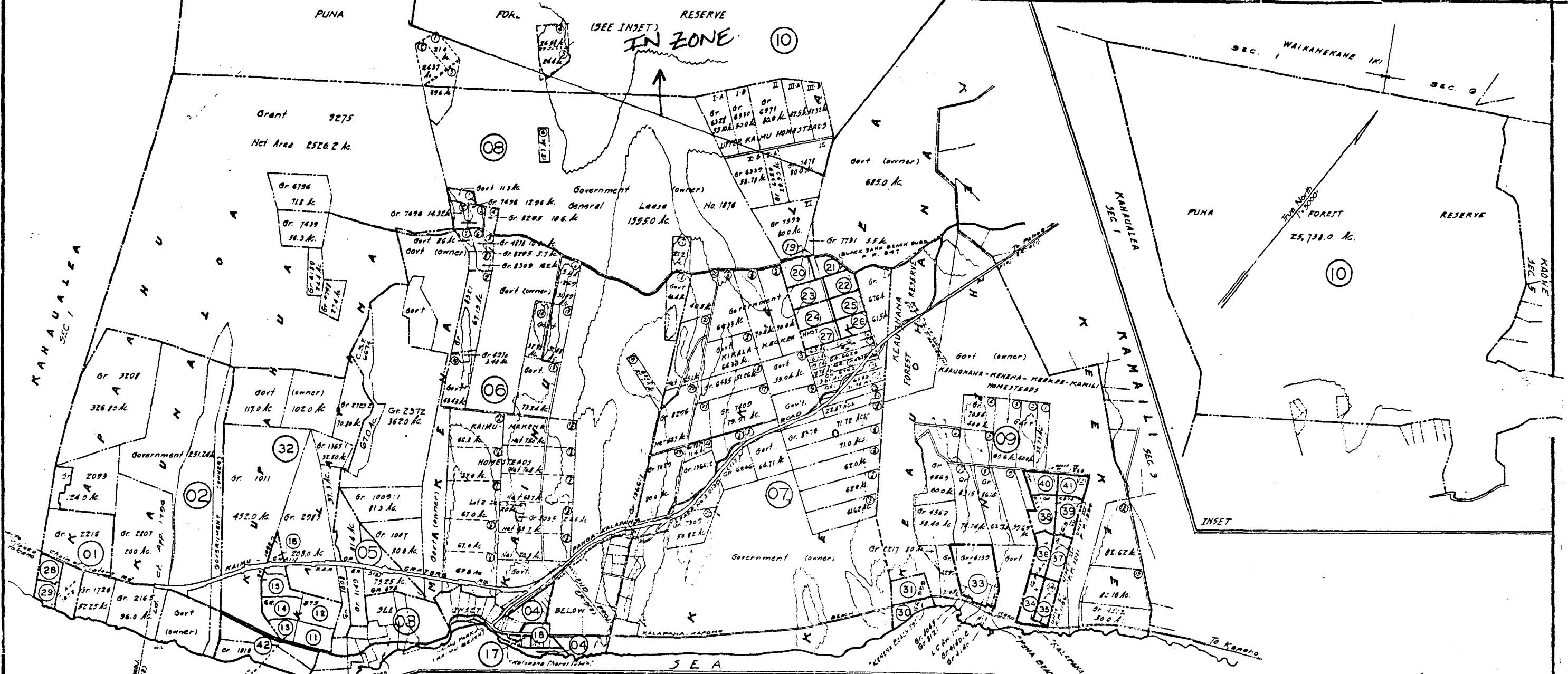

THIRD DIVISION	
ZONE	SEC.
1	2
CONTAINING PLATS	
SCALE 1 IN. = 2000 FT.	

RESERVE ZONE

K A H A U A I L E A
ZONE I, SECTION I

P U N A

F O R E S T
P L A T 10

State of Hawaii

1,007.70 ACS.
(1,995.0 ACS.)

James Campbell Trust Est.
2576.2 ACS.

GRANT 9275

Annie Kakuai - 1/4
Elias Kakuai, Jr. - 1/4
Elias - Adm.
Gr. 6796

David R. Keino
56.5 ACS.
Gr. 7439

Louise (Kama) John
Jennie K. (Calimata) Anai
Bessie K. Watson & Rob. Clarence A. H.
Mary K. Kahilima
Charles Anai, Jr. & J. Jennie C. - 1/2
Louise K. Kalihonohano
James M. Pa - 1/2

HULUNANAI

PLAT 06

UPPER PUNA ROAD

K A I M U
True North
1"=1000'

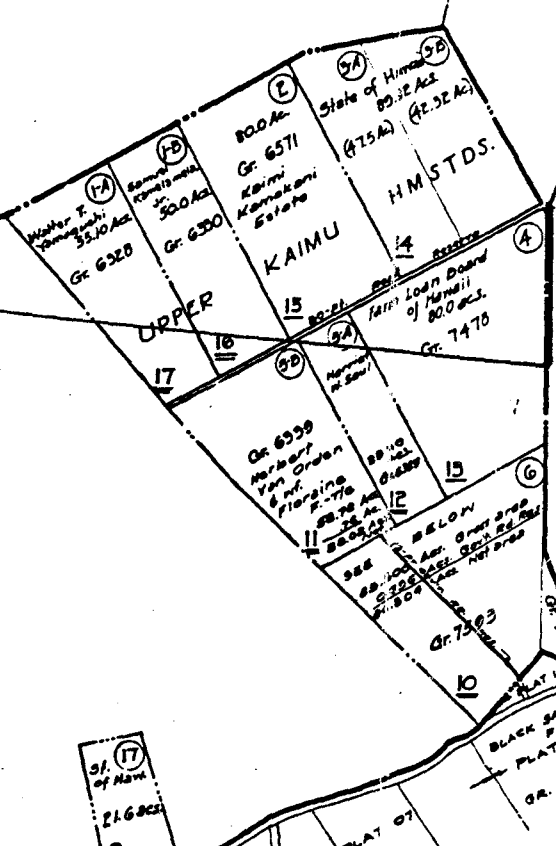

PARCEL 10:
Janet Kumala, Jr.
Thelma K. Richards,
Carole K. Richards,
Alfred Kumala,
Bobby K. Adams,
Clarence Kumala,
Richard Adams,
Raymond K. Arnolds, Jr.
-7/c

Dropped Parcels - 7,

THIRD DIVISION		
ZONE	SEC.	PLAT
1	2	08
CONTAINING 17 PARCELS		
SCALE: 1 in. = 1000 ft.		

W A I K A H E K A

H E I K I
HAWAIIAN SEC. 6 ACRES
PLAT 22 PLAT 23 PLAT 43 PLAT 44

State of Hawaii

MAKUU

POPOKI

PUNA FOREST RESERVE

8890.275 Ac.

PLAT 09

SECTION 5

HALONA

State of Hawaii
Dept. of Land & Natural Resources
Natural Area Reserve Commission
Exec. Order 5108
"WAO KELE O PUNA NATURAL AREA RESERVE"

KAOHE PLAT 01
HOMESTEADS

IN ZONE

State of Hawaii
1936 Ac.

SEC 5, PLAT 09

12843.891 Ac.

PLAT 08

UPPER KAMU
HOMESTEADS

KAMAILI HOMESTEADS

SECTION PLAT

To Pahoa

01

THIRD DIVISION		
ZONE	SEC.	PLAT
1	2	10
CONTAINING		PARCELS
SCALE: 1 in. = 2000 ft.		

KILAUEA MIDDLE EAST RIFT
GEOTHERMAL RESOURCE SUBZONE

Island of Hawaii

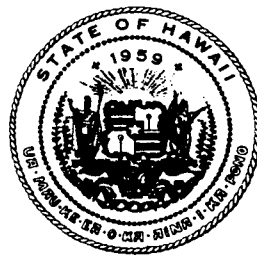

State of Hawaii
BOARD OF LAND AND NATURAL RESOURCES

April 1986

KILAUEA MIDDLE EAST RIFT
GEOTHERMAL RESOURCE SUBZONE

Legal Authority

Pursuant to Sections 205-5.1 and 205-5.2, Hawaii Revised Statutes, as amended by Act 151, Session Laws of Hawaii 1984, and Title 13, Chapter 184, Administrative Rules, as amended, the Board of Land and Natural Resources, State of Hawaii, has designated the Kilauea Middle East Rift, Island of Hawaii, as a Geothermal Resource Subzone (GRS).

Location

The subzone area is designated on the attached map identified as the Kilauea Middle East Rift Geothermal Resource Subzone. The subzone area contains approximately 9,014 acres more or less, subject to verification, and is located within the area formerly known as the Wao Kele 'O Puna Natural Area Reserve and includes a portion of the Upper Kaimu Homesteads. The GRS subzone area includes the following Tax Map Keys (TMK):

Tax Map Keys

TMK 1-2-08: portions of 8', 12', and 13'
TMK 1-2-08: 14' and 15'
TMK 1-2-08: portions of 16' and 17'
TMK 1-2-10: portions of 1' and 3'

The attached map defining the boundaries of the designated subzone is adapted from U.S. Geological Survey topographic maps (Kalalua and Pahoa South Quadrangles).

Questions regarding the GRS and requests for information may be directed to the Division of Water and Land Development, Department of Land and Natural Resources, Room 227, 1151 Punchbowl Street, Kalanimoku Building, Honolulu, Hawaii 96813 (telephone 548-7539).

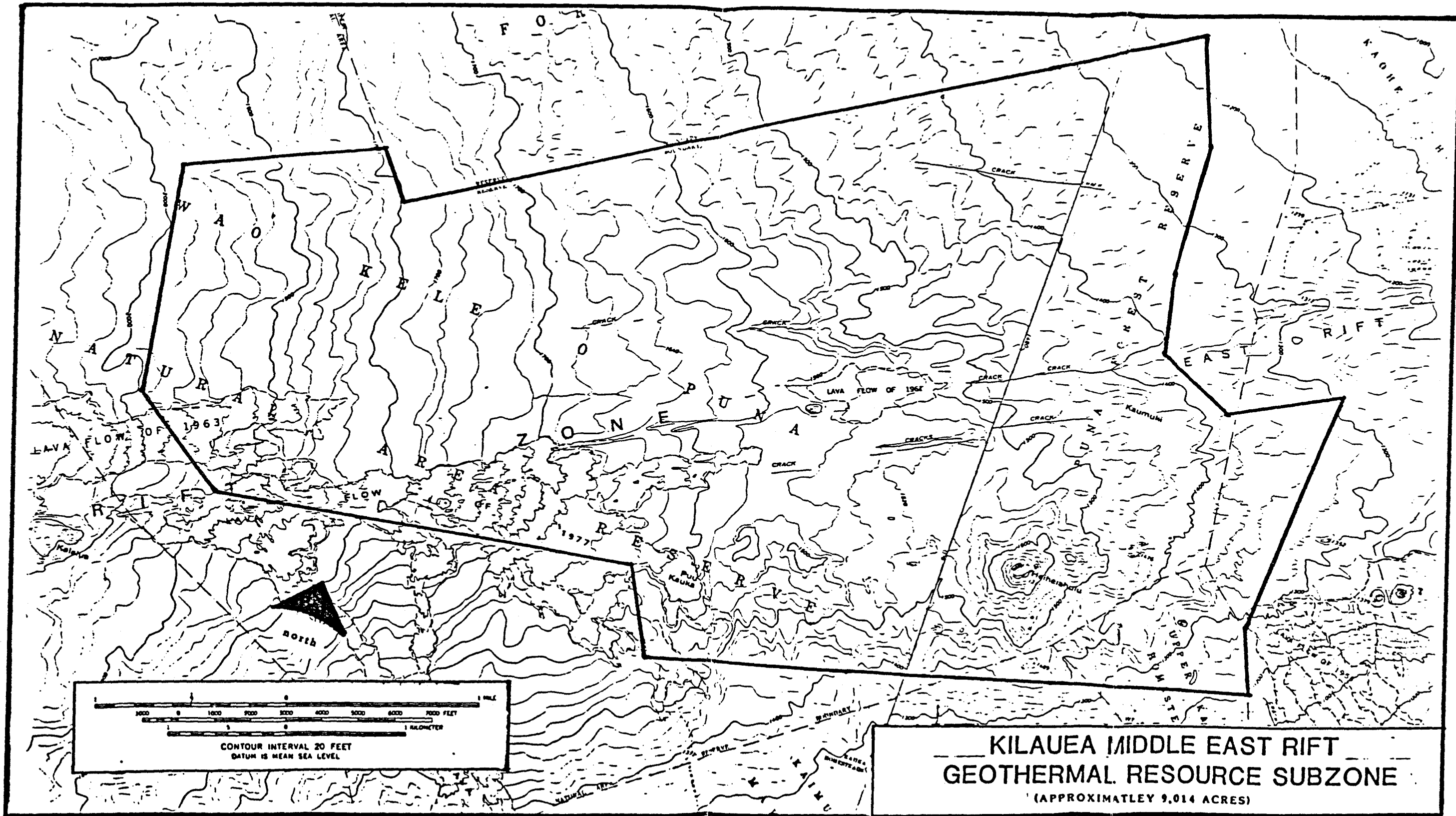

**KILAUEA MIDDLE EAST RIFT
GEOHERMAL RESOURCE SUBZONE**
(APPROXIMATELY 9,014 ACRES)

KILAUEA MIDDLE EAST RIFT
GEOTHERMAL RESOURCE SUBZONE

Island of Hawaii

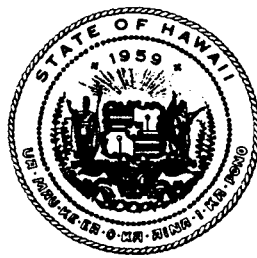

State of Hawaii
BOARD OF LAND AND NATURAL RESOURCES

April 1986

KILAUEA MIDDLE EAST RIFT
GEOTHERMAL RESOURCE SUBZONE

Legal Authority

Pursuant to Sections 205-5.1 and 205-5.2, Hawaii Revised Statutes, as amended by Act 151, Session Laws of Hawaii 1984, and Title 13, Chapter 184, Administrative Rules, as amended, the Board of Land and Natural Resources, State of Hawaii, has designated the Kilauea Middle East Rift, Island of Hawaii, as a Geothermal Resource Subzone (GRS).

Location

The subzone area is designated on the attached map identified as the Kilauea Middle East Rift Geothermal Resource Subzone. The subzone area contains approximately 9,014 acres more or less, subject to verification, and is located within the area formerly known as the Wao Kele 'O Puna Natural Area Reserve and includes a portion of the Upper Kaimu Homesteads. The GRS subzone area includes the following Tax Map Keys (TMK):

Tax Map Keys

TMK 1-2-08: portions of 8, 12, and 13
TMK 1-2-08: 14 and 15
TMK 1-2-08: portions of 16 and 17
TMK 1-2-10: portions of 1 and 3

The attached map defining the boundaries of the designated subzone is adapted from U.S. Geological Survey topographic maps (Kalalua and Pahoa South Quadrangles).

Questions regarding the GRS and requests for information may be directed to the Division of Water and Land Development, Department of Land and Natural Resources, Room 227, 1151 Punchbowl Street, Kalanimoku Building, Honolulu, Hawaii 96813 (telephone 548-7539).